

## BALL DROP FRAC VALVES

### APPLICATION

The Fracturing Sleeve is used for multistage hydraulic fracturing. The valve is opened by pumping the corresponding activation ball into a special seat and then pressurizing the liner.

### DESIGN FEATURES AND ADVANTAGES

- The activation pressure can be adjusted prior to running;
- Once activated, the locking mechanism holds the sleeve in the open position;
- If necessary, the ball seats can be milled out to provide a full-bore diameter;
- The tool can be used with acid resistant, composite and soluble balls;
- The tool OD provides accident-free running.



## SPECIFICATIONS

Liner size,in	4	4 1/2	4 1/2	5 1/2	5 3/4
Tool OD,in	4,65	5,24	5,75	6,54	6,54
Tool ID,in	3,46	3,90	3,90	4,84	5,08
Activation pressure, psi	3 500	3 500	3 500	3 000	2 700
Pressure rating, psi	10 000	10 000	10 000	10 000	10 000
Max working temperature, °F	250	300	300	250	250
Thread size*	4,0	4,5	4,5	5,5	5,75

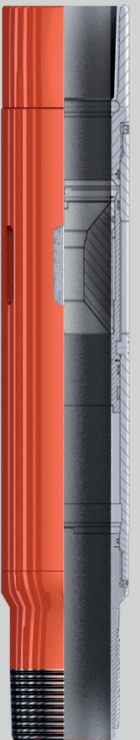

\*Thread type, metallurgy and elastomers are as per Customer`s requirements